

Sunday, December 08, 2013

Yvonne Court Park Dr, Goodlettsville, TN  
Sumner County, TN parcel# 143A D 037.00

## Property Report

### Location

<b>Property Address</b>	Yvonne Court Park Dr Goodlettsville, TN
<b>Subdivision</b>	Woodwyn Hills Sec 1
<b>County</b>	Sumner County, TN

### Current Owner

<b>Name</b>	Woodwyn Hills Homeowners Assoc Inc
<b>Mailing Address</b>	Po Box 670 Goodlettsville, TN 37070-0670

### Property Summary

<b>Property Type</b>	Residential
<b>Land Use</b>	Household Unit
<b>Improvement Type</b>	
<b>Square Feet</b>	

### General Parcel Information

<b>Parcel/Tax ID</b>	143A D 037.00
<b>Special Int</b>	000
<b>Alternate Parcel ID</b>	
<b>Land Map</b>	143A
<b>District/Ward</b>	06
<b>2010 Census Trct/Blk</b>	210.05/3

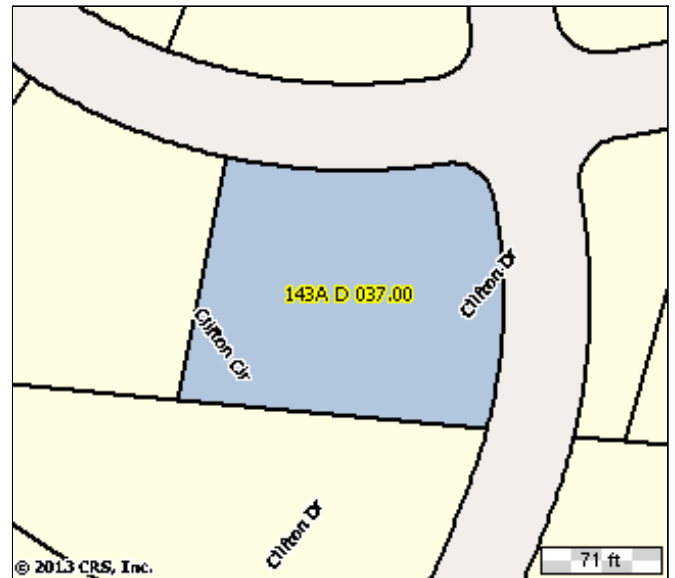

### Sales History through 11/26/2013

Date	Amount	Buyer/Owners	Instrument	Quality	Book/Page or Document#
03/08/2004		Woodwyn Hills Homeowners Assoc Inc			1959/835
08/27/1996		Woodwyn Hills Llc C/O One Northchase			623/76
02/11/1994		Phillips Edward R & C Wayne Meadows			400/768
10/28/1988					53/620

### Tax Assessment

Appraisals	Amount	Taxes	Amount	Jurisdiction	Rate
<b>Assessment Year</b>	2011				
<b>Tax Year</b>	2011	<b>City Taxes</b>	\$5.55	Goodlettsville	0.6338
<b>Appraised Land</b>	\$3,500	<b>County Taxes</b>	\$17.68	Sumner	2.0208
<b>Appraised Improvements</b>	\$0	<b>Total Taxes</b>	<b>\$23.23</b>		
<b>Total Tax Appraisal</b>	<b>\$3,500</b>	<b>Exempt Amount</b>			
<b>Total Assessment</b>	<b>\$875</b>	<b>Exempt Reason</b>			

### Mortgage History

No mortgages were found for this parcel.

### Property Characteristics: Building

No Buildings were found for this parcel.

**Property Characteristics: Extra Features**

No extra features were found for this parcel.

**Property Characteristics: Lot**

<b>Land Use</b>	Household Unit	<b>Lot Dimensions</b>	126.74 X 144.89 IRR
<b>Block/Lot</b>		<b>Lot Square Feet</b>	
<b>Latitude/Longitude</b>	36.341857°/-86.707993°	<b>Acreage</b>	

**Property Characteristics: Utilities/Area**

<b>Gas Source</b>	Public	<b>Road Type</b>	Curb/Gut Pav
<b>Electric Source</b>	Public	<b>Topography</b>	Rolling
<b>Water Source</b>	Public	<b>District Trend</b>	Static
<b>Sewer Source</b>	Public	<b>Special School District 1</b>	0
<b>Zoning Code</b>		<b>Special School District 2</b>	0
<b>Owner Type</b>	Private		

**Legal Description**

<b>Subdivision</b>	Woodwyn Hills Sec 1	<b>Plat Book/Page</b>	15 /66
<b>Block/Lot</b>		<b>Description</b>	Common Area & Open Space
<b>District/Ward</b>	06		

**Flood Zone Information**

Zone Code	Flood Risk	Description	FIRM Panel ID	Firm Panel Eff. Date
X	Minimal	Area of minimal flood hazard, usually depicted on FIRMs as above the 500-year flood level.	47165C0379G	04/17/2012

Zone Source: FEMA DFIRM Data